

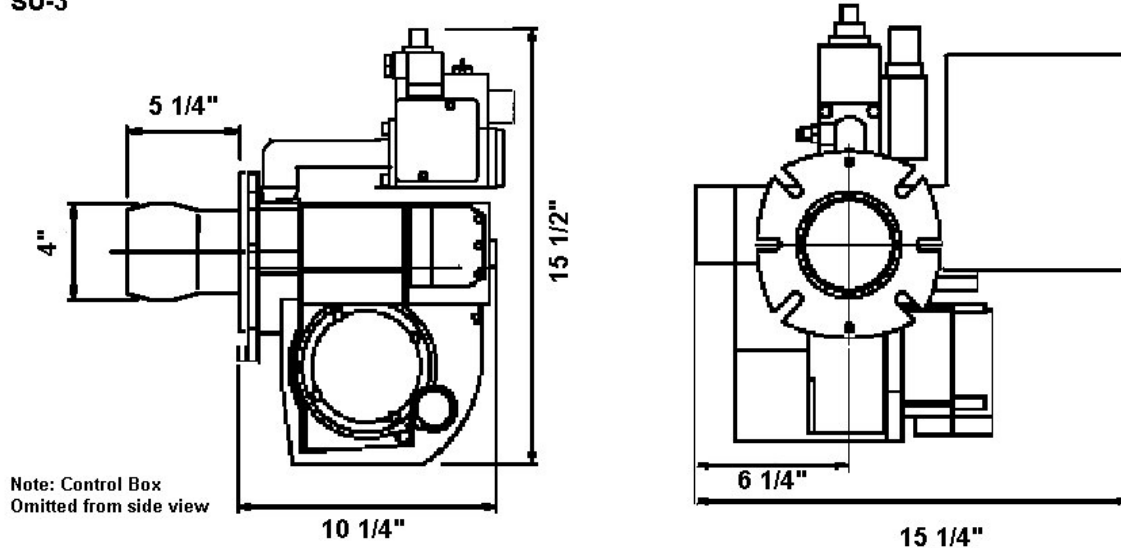

Light Commercial Diffuse Flame Power Gas Burner: SU-3

Technical Dimensions SU-3



NOTE: The above measurements are maximum measurements. Depending on the components used, the measurements may vary.

Burner Model	Tube Length	Fuel	Capacity in BTU/H		Auxiliary Electric Power		Total Amps	Gas Conn.	Weight	Listing
			Min	Max	Primary	Secondary				
SU-3	5 1/4" or 14"	N.Gas/LP US/ Canada	199,000	400,000	120V 60Hz 1PH	24V	3 or less	1/2"	39 lbs.	

- The SU-3 is a direct spark, pre-mixed, diffuse flame power gas burner.
- Available outside air attachment for fresh air and direct vent applications
- Suitable for OEM applications, oil to gas conversions and retrofits.
- Firing rate adjusted by altering gas pressure, head and air settings.
- Available with Honeywell S89F and Fenwal 2466H control
- Honeywell gas valve standard.
- The SU-3 is used in a variety of applications, such as: residential and commercial heating, process heating, bakery ovens, smoke houses and incinerators.

Mass. Plbg Board # G3-0904--16

NYC Dept. of Buildings MEA # 363-99-E

Heat Wise, Inc.
 1528 Rocky Point Road
 Middle Island NY 11953
 P: (631)-345-0447
 F: (631)-345-0451
www.heatwise.com